

DIAMOND WIRES

WIRE SAW TECHNOLOGY

DIAMOND WIRES & ACCESSORIES

Diamond Wires DSS

Order no.	Type	Application area	Perls per m	Perl-Ø -mm-	Wet cutting	Dry cutting
10004003	DSS Orange 10,5	concrete with up to 3 % shares of reinforcement, soft to hard aggregates	40	10,5	x	
10004002	DSS Blau 11,0	concrete with up to 8 % shares of reinforcement, to hard aggregates	40	11,0	x	
10003651	DSS Schwarz 10,5	concrete, stainless steel, premium steel, fiber plastic, hard natural stone, etc.	40	10,5	x	x*
10003652	DSS Schwarz Synchro 10,5	concrete with 3-8 % shares of reinforcement, to extremely hard aggregates	40	10,5	x	
10003661	DSS Schwarz 11,0	concrete & reinforced concrete up to 8 % shares of reinforcement, stainless steel, cast iron & other metals	48	11,0	x	x
10003653	DSS Schwarz 12,0	masonry and concrete for draining	40	12,0	x	
50004330	DSS SOLID Performance 10,2 NEU	concrete & reinforced concrete, vacuum brazed	40	10,2	x	
50004526	DSS MAXX Performance 10,2 NEU	metal and steel, vacuum brazed	53	10,2	x	x**

*) Dry cutting in concrete
**) optionally possible



Accessories for diamond wires

Pos.	Description	Order no.
1	steel wire clamps (25 pcs.) for closing diamond wires	70011172
1	steel wire clamps type (25 pcs.) for closing of heavily used diamond wires	10003646
2	articulated joints (5 pcs.) for closing and opening of diamond wires	10003643
3	spare pin for articulated joints (1 pcs.)	10003644
4	device for opening and closing of articulated joints	70002875
5	hydraulic jointing clamp with press chucks for closing diamond wires, press force 8 tonnes	30000509

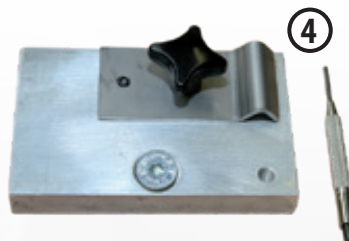

Band saw blade CSB-HM 3750x27

Carbide tipped saw blade for cutting light building materials (Poroton and similar) up to a maximum bulk density of 0,9 g/cm³.

Optimal tool for the CEDIMA band saw CBAS-500 (see page 44)



Technical Data		CSB-HM 3750x27
Order-no.		50009324
Band saw blade length	mm	3750
Band saw blade height	mm	27
Band saw blade thickness	mm	0,9
Tooth pitch		3 ZpZ